

INSTALLATION NOTES

- 1) ACCESS: ALL EQUIPMENT MUST ACCESS THE SITE ALONG THE ACCESS ROADS SHOWN ON THIS PLAN. APPROVED PRIVATE ROADS.
- 2) VEHICLE AND EQUIPMENT ACCESS CROSSING MAY BE INSTALLED IF APPROVED BY THE ENVIRONMENTAL INSPECTOR.
- 3) WORK SPACE: WORK SPACE LIMITS ARE DETERMINED. CLEANING WILL BE REQUIRED AT ALL WORK SPACES. CLEANING POINTS WILL BE IDENTIFIED BY THE CONTRACTOR. CLEANING POINTS WILL BE IDENTIFIED BY THE CONTRACTOR. CLEANING POINTS WILL BE IDENTIFIED BY THE CONTRACTOR. CLEANING POINTS WILL BE IDENTIFIED BY THE CONTRACTOR.
- 4) WATER SOURCE: DRAIN WATER AND PRE-INSTALLATION HYDROSTATIC TESTING WATER SHALL BE SUPPLIED FROM THE WATER SOURCE IDENTIFIED ON THIS PLAN. THE CONTRACTOR SHALL INSTALL PUMPS AND PIPING TO OBTAIN WATER (WHERE APPROVED).
- 5) HYDROSTATIC TEST: PRE-INSTALLATION HYDROSTATIC TEST SHALL BE CONDUCTED IN ACCORDANCE WITH THE REQUIREMENTS OF THE PROJECT. THE CONTRACTOR SHALL INSTALL AN ENERGY-DISSIPATING DEVICE AS SHOWN ON THIS PLAN.
- 6) CONSTRUCTION: ALL PIPES SHALL BE SET IN ACCORDANCE WITH THE REQUIREMENTS OF THE PROJECT. THE CONTRACTOR SHALL INSTALL AN ENERGY-DISSIPATING DEVICE AS SHOWN ON THIS PLAN.
- 7) CONSTRUCTION: ALL PIPES SHALL BE SET IN ACCORDANCE WITH THE REQUIREMENTS OF THE PROJECT. THE CONTRACTOR SHALL INSTALL AN ENERGY-DISSIPATING DEVICE AS SHOWN ON THIS PLAN.
- 8) CONSTRUCTION: ALL PIPES SHALL BE SET IN ACCORDANCE WITH THE REQUIREMENTS OF THE PROJECT. THE CONTRACTOR SHALL INSTALL AN ENERGY-DISSIPATING DEVICE AS SHOWN ON THIS PLAN.
- 9) CONSTRUCTION: ALL PIPES SHALL BE SET IN ACCORDANCE WITH THE REQUIREMENTS OF THE PROJECT. THE CONTRACTOR SHALL INSTALL AN ENERGY-DISSIPATING DEVICE AS SHOWN ON THIS PLAN.
- 10) CONSTRUCTION: ALL PIPES SHALL BE SET IN ACCORDANCE WITH THE REQUIREMENTS OF THE PROJECT. THE CONTRACTOR SHALL INSTALL AN ENERGY-DISSIPATING DEVICE AS SHOWN ON THIS PLAN.
- 11) CONSTRUCTION: ALL PIPES SHALL BE SET IN ACCORDANCE WITH THE REQUIREMENTS OF THE PROJECT. THE CONTRACTOR SHALL INSTALL AN ENERGY-DISSIPATING DEVICE AS SHOWN ON THIS PLAN.
- 12) CONSTRUCTION: ALL PIPES SHALL BE SET IN ACCORDANCE WITH THE REQUIREMENTS OF THE PROJECT. THE CONTRACTOR SHALL INSTALL AN ENERGY-DISSIPATING DEVICE AS SHOWN ON THIS PLAN.
- 13) CONSTRUCTION: ALL PIPES SHALL BE SET IN ACCORDANCE WITH THE REQUIREMENTS OF THE PROJECT. THE CONTRACTOR SHALL INSTALL AN ENERGY-DISSIPATING DEVICE AS SHOWN ON THIS PLAN.

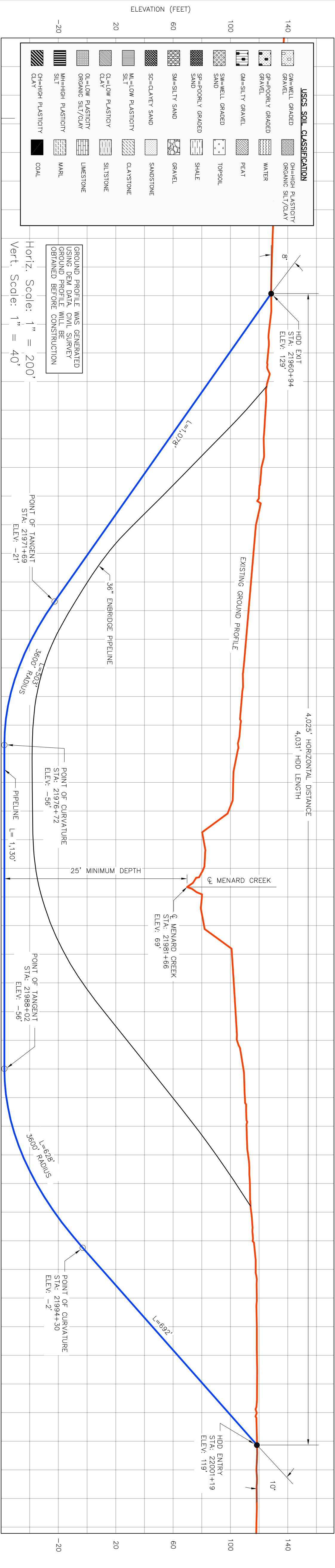

LEGEND

- POINT OF INTERSECTION (P.I.)
- ENTRY OR EXIT POINT
- GEOTECHNICAL BOREROLE
- POWERPOLE
- MANHOLE PIPE
- PIPELINE
- FOREIGN PIPELINE
- EDGE OF WATER
- PRIVATE ACCESS ROAD R/W ROAD
- COUNTY BOUNDARY
- WATER LEVEL
- USACE CONSTRUCTION REFERENCE POINT
- WETLANDS
- PERMANENT EASEMENT
- TEMPORARY EASEMENT
- EXTRA WORKSPACE

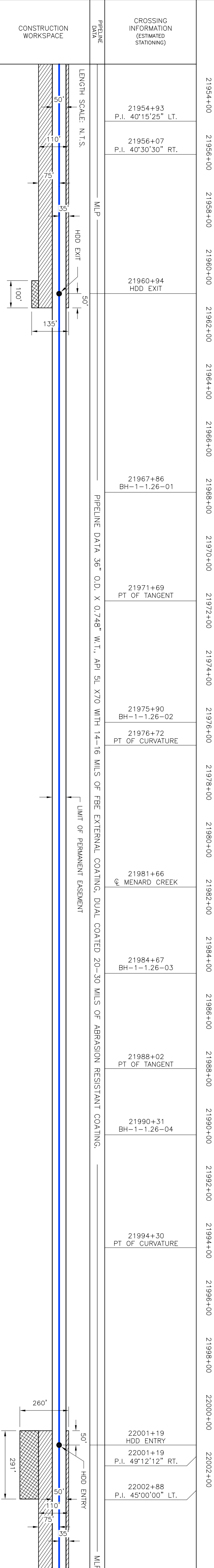

LEGEND

- POINT OF INTERSECTION (P.I.)
- ENTRY OR EXIT POINT
- GEOTECHNICAL BOREROLE
- POWERPOLE
- MANHOLE PIPE
- PIPELINE
- FOREIGN PIPELINE
- EDGE OF WATER
- PRIVATE ACCESS ROAD R/W ROAD
- COUNTY BOUNDARY
- WATER LEVEL
- USACE CONSTRUCTION REFERENCE POINT
- WETLANDS
- PERMANENT EASEMENT
- TEMPORARY EASEMENT
- EXTRA WORKSPACE

ENVIRONMENTAL MITIGATION/RECLAMATION	
TOPSOIL SALVAGE METHOD	
STREAMS	
WETLANDS	
TIMING CONSTRAINTS	
MILEPOST	
MONITORING	
RECLAMATION	
SPECIAL CONSIDERATIONS	

REFERENCE DRAWINGS	
DRAWING NO.	TITLE
11042 HDD XREF_15	11042 HDD XREF_15.dwg
TC_UD_BR_UH	TC_UD_BR_UH.dwg
NOTES-LEGEND	
NOTES-LEGEND.dwg	

CROSSING INFORMATION (ESTIMATED STATIONING)	
21954+93	P.I. 40°15'25" LT.
21956+07	P.I. 40°30'30" RT.
21960+94	HDD EXIT
21967+86	BH-1-1.26-01
21971+69	PT OF TANGENT
21975+90	BH-1-1.26-02
21976+72	PT OF CURVATURE
21981+66	MENARD CREEK
21984+67	BH-1-1.26-03
21988+02	PT OF TANGENT
21990+31	BH-1-1.26-04
21994+30	PT OF CURVATURE
22001+19	HDD ENTRY
22001+19	P.I. 49°12'12" RT.
22002+88	P.I. 45°00'00" LT.
22002+100	

REVISION		
REV. NO.	DATE	DESCRIPTION
6	03.15.10	ISSUED FOR CONTRACT PRE-AWARD
5	09.08.09	ISSUED FOR RFP PACKAGE
4	07.27.09	ISSUED FOR BID REVIEW
3	06.22.09	ISSUED FOR BID REVIEW
2	05.13.09	ISSUED FOR J.D. HARR REVIEW
1	03.19.09	ISSUED FOR TROW REVIEW
0	11.19.08	ISSUED FOR UNITED STATES DEPARTMENT OF STATE (7.31.08 CQ)

UNIVERSAL
UNIVERSAL ENGRG. INC.

TransCanada
In partnership with

SCALE: AS SHOWN

4386-03-MI-03-001

REV. 6

TO BE DETERMINED

TC_UD_BR.DWG 22X34

CADD DRAWING: DO NOT MAKE MANUAL REVISIONS

PLOTTED SIZE: ANSI D (22X34)

DESIGNFILE